



SYRUP SYSTEMS

1. **BIB Racks**
2. **BIB Pumps**
3. **Syrup Fittings**
4. **BIB Connectors**

Assembled Rack Systems

Assembled rack systems are our specialty! Constructed with the highest quality materials, state-of-the-art technology, and customized to your specifications, you can choose from...

- Inclined or flat rack shelves
- Single, double or triple wide shelves
- Top, right or left side pump mounts
- Flojet or Shurflo BIB pumps
- Flojet or Shurflo transfer valves
- Lancer, Liqui-Box, Rapak and/or Scholle connectors
- Regulator management systems
- With or without top shelf for additional storage

Simply add a CO₂ tank, tubing between the dispenser and rack, connect the bag-in-box (BIB) boxes to the assembled rack system and you're ready to serve!

Inclined or flat rack - what's the difference?

Inclined rack systems are designed for gravity feed BIB boxes. Due to the incline, boxes must be placed horizontally.

Some syrup bags have an internal tube to help empty the syrup, therefore the boxes can lay flat rather than inclined. Flat shelves are easier to load, and allow BIB boxes to be placed on their narrowest side which maximizes storage capacity while minimizing the storage footprint - a great way to save floor space!



Horizontal BIB Placement



Vertical BIB Placement

Bag-In-Box Size	Horizontal Capacity Per Rack Shelf			Vertical Capacity Per Rack Shelf		
	1-wide	2-wide	3-wide	1-wide	2-wide	3-wide
2.5 gallon boxes	1 box	2 boxes	3 boxes	3 boxes	6 boxes	8 boxes
3 gallon boxes	1 box	2 boxes	3 boxes	1 box	4 boxes	6 boxes
5 gallon boxes	1 box	2 boxes	3 boxes	1 box	3 boxes	4 boxes

Advanced Beverage Solutions • Ph: 877-814-2271 • Fax: 847-524-1710 • E-mail: abscs@absone.com • Visit us online at www.absone.com



Standard Assembled Rack Systems

Part Number	BIB Boxes/Pumps	Description	Width"	Depth"	Height"	Shipping Weight Lbs.
8518032306	6 Box	2-wide X 3 shelf side mount	33	20	36	66
8518032306SP	6 Box	2-wide X 3 shelf top mount	27	20	60	74
8518033206	6 Box	3-wide X 2 shelf side mount	45	20	24	62
8518033206SP	6 Box	3-wide X 2 shelf top mount	39	20	48	70
8518032408	8 Box	2-wide X 4 shelf side mount	33	20	48	88
8518032408SP	8 Box	2-wide X 4 shelf top mount	27	20	72	96
8518033309	9 Box	3-wide X 3 shelf side mount	45	20	36	93
8518033309SP	9 Box	3-wide X 3 shelf top mount	39	20	60	101
8518032510	10 Box	2-wide X 5 shelf side mount	33	20	60	110
8518032510SP	10 Box	2-wide X 5 shelf top mount	27	20	84	118
8518032612	12 Box	2-wide X 6 shelf side mount	33	20	72	132
8518032612SP	12 Box	2-wide X 6 shelf top mount	27	20	96	140
8518033412	12 Box	3-wide X 4 shelf side mount	45	20	48	124
8518033412SP	12 Box	3-wide X 4 shelf top mount	39	20	72	132
8518033515	15 Box	3-wide X 5 shelf side mount	45	20	60	155
8518033515SP	15 Box	3-wide X 5 shelf top mount	39	20	84	163
8518033618	18 Box	3-wide X 6 shelf side mount	45	20	72	186
8518033618SP	18 Box	3-wide X 6 shelf top mount	39	20	96	194

Rack Components	Width"	Depth"	Height"	Weight Lbs.
1-wide shelf	15	19	12	6
2-wide shelf	27	19	12	8
3-wide shelf	39	19	12	10
2-wide top shelf (optional)	27	19	12	12
3-wide top shelf (optional)	39	19	12	14
Side mount pumps	6			0
Top mount pumps 2-wide	27	10	24	8
Top mount pumps 3-Wide	39	10	24	10
Pump weight				4
Packaging weight/box				3



Modular BIB Rack Components



Louvered Inclined shelf



Louvered top shelf



Stainless steel top cover



Louvered top pump mount single bar



Louvered top pump mount double bar



Louvered center pump mount



Standard flat shelf



Standard top shelf



Spacer frame



Top pump mount single bar



Top pump mount double bar



Standard center pump mount

	ONE box wide		TWO boxes wide		THREE boxes wide	
Shelf style	Part #	Size W x H x D"	Part #	Size W x H x D"	Part #	Size W x H x D"
Louvered inclined shelf w/o casters	1B1FJG	15 x 12 x 17.5	2B1FJG	27 x 12 x 17.5	3B1FJG	39 x 12 x 17.5
Louvered top shelf	1BTSFJG	15 x 8.5 x 17.5	2BTSFJG	27 x 8.5 x 17.5	3BTSFJG	39 x 8.5 x 17.5
Louvered SS top cover**	N/A	N/A	2BTCSS	27 x 1 x 17.5	2BTCSS	39 x 1 x 17.5
Louvered top pump mt. single bar	C1BPM2FJG	15 x 24 x 1	C2BPM3FJG	27 x 24 x 1	C3BPM4FJG	39 x 24 x 1
Louvered top pump mt. double bar	C1BPM4FJG	15 x 24 x 1	C2BPM6FJG	27 x 24 x 1	C3BPM8FJG	39 x 24 x 1
Louvered center pump mount	N/A	N/A	2CPMFJG	27 x 15.5 x 17.5	3CPMFJG	39 x 15.5 x 17.5
Standard flat bottom shelf w casters	C1BCFJ*	15 x 15 x 19	C2BCFJ*	28 x 15 x 19	C3BCFJ*	39 x 15 x 19
Standard flat shelf without casters	1BFFJ	15 x 11 x 19	2BFFJ	28 x 11 x 19	3BFFJ	39 x 11 x 19
Standard flat rack top shelf	1BTSFJ	15 x 8.5 x 19	C2BTSFJ	28 x 8.5 x 19	3BTSFJ	39 x 8.5 x 19
Standard flat rack SS top cover**	N/A	N/A	C2BTCSS	28 x 1 x 19	3BTCSS	39 x 1 x 19
Standard top pump mt. single bar	C1BPM2FJ	15 x 22 x 1	C2BPM3FJ	28 x 22 x 1	C3BPM6FJ	39 x 22 x 1
Standard top pump mt. double bar	C1BPM4FJ	15 x 22 x 1	C2BPM6FJ	28 x 22 x 1	C3BPM8FJ	39 x 22 x 1
Standard spacer frame	N/A	N/A	C2FSJ	28 x 11 x 19	C3FSJ	28 x 11 x 19
Vertical louvered racks (3/ctn) Dimensions per shelf	N/A	N/A	2BVFFJG/ 2BVIFJG	28 x 14 x 19	3BVFFJG/ 3BVIFJG	39 x 14 x 19
Vertical rack top shelf	N/A	N/A	C2BTSFJG	28 x 8.5 x 19	C3BTSFJG	39 x 8.5 x 19
Vertical top pump mount	N/A	N/A	C2BPM6FJG	28 x 22 x 1	C3BPM6FJG	39 x 22 x 1
Vertical louvered center pump mt.	N/A	N/A	2CPMVJG	28 x 15.5 x 19	3CPMVJG	39 x 15.5 x 19
Vertical spacer frame	N/A	N/A	C2FFJ	28 x 14 x 19	C3FFJ	39 x 14 x 19

Louvered enables BIB pumps to be mounted on the rack rather than on a separate pump panel. Great space saver!

*Casters included

**SS top cover requires a top shelf



Modular BIB Rack Accessories



Part Number	50101900	5010200	CN4	CO	COLOCK	RL1	ISA1FJ & ISA2FJ
Description	Plastic end cap for shelves	2" plastic connector for shelves	4" plastic rack connector for top pump mt.	Caster for BIB rack	Locking caster for BIB rack	Adjustable leveling leg	Incline adapter for BIB rack



McCann's racks are made of sturdy cold-rolled steel with nickel chrome plating. Rack components are shipped knocked-down, in one or more boxes (number of boxes shown in parentheses) and require assembly.

Standard racks are 16" deep and 10-1/4" high. Flex racks for vertical/side box placement that enable more BIB boxes per shelf are 16" deep and 12-1/4" high.

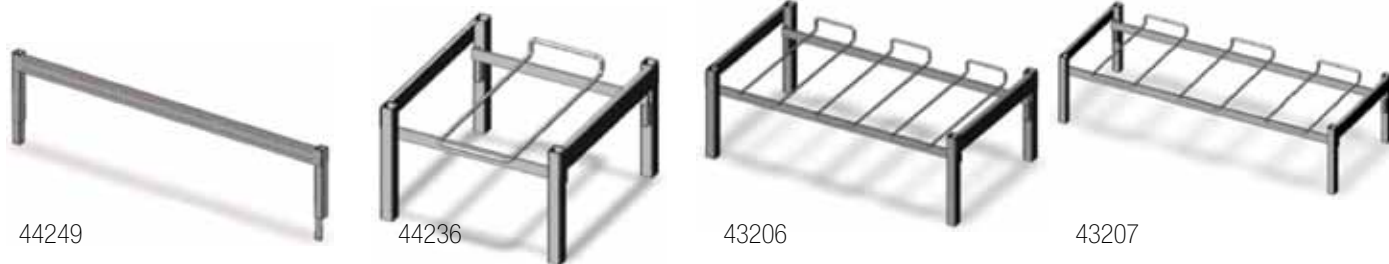

Standard Rack	ONE box wide, 15"	TWO boxes wide, 28"	THREE boxes wide, 41"
One shelf high, 10-1/4"	44236 (1 BIB box)	43206 (2 BIB boxes)	43207 (3 BIB boxes)
Two shelves high, 20-1/2"	N/A	44240 (4 BIB boxes)	N/A
Three shelves high, 30-3/4"	N/A	44241 w riser (6 BIB boxes)	44243 w riser (9 BIB boxes)
Riser/spacer, adds 8-1/2"	N/A	44249	44244
Flex Rack for vertical BIB boxes		TWO boxes wide, 28"	
One shelf high, 12-1/4"		44238 (3 BIB boxes)	
Two shelves high, 28-1/2"		44239 w riser (6 BIB boxes)	
Platform rack		44235	

Expanding Metro Style BIB Rack Systems



Expanding racks widen to 39" or narrow to 27" to fit your space constraints. BIB boxes can be placed horizontally or vertically. The rack comes disassembled, minimizing shipping fees. Slide tracks on both sides of the rack enable pumps and regulators to be mounted on the right or left side, or with the optional top pump mount pumps and regulators can be mounted above the rack.

Part Number	Description
9448401	BIB rack system: 4 shelves, 12 joiners, 8 caps
9448601	Overhead pump mount
9448100	End cap
9448200	Shelf connector
9448300	Rack leveler
9442602	Rack wall anchors (sold in pairs)
9475300	P-mounting base plate
9446700	Standard (slide track) base plate*
9446900	Accessory (ASV/secondary regulator) mtg. bracket
2224301	3 pump slide track for standard base plate*
2224304	4 pump slide track for standard base plate*
2224305	5 pump slide track for standard base plate*
2224306	6 pump slide track for standard base plate*

* No clips or screws are needed to mount pumps or regulators on the slide track using standard base plates.





SYRUP SYSTEMS

Economy Welded One Piece BIB Rack Systems



	ONE box wide		TWO boxes wide		THREE boxes wide	
Shelf style	Part #	Size W x H x D"	Part #	Size W x H x D"	Part #	Size W x H x D"
Single inclined shelf	121SGBI	15 x 12.5 x 17	241SGBI	27 x 12.5 x 17	361SGBI	39 x 12.5 x 17
Double inclined shelf	122SGBI	15 x 23 x 17	242SGBI	27 x 23 x 17	362SGBI	39 x 23 x 17
Triple inclined shelf	N/A	N/A	243SGBI	27 x 33.5 x 17	363SGBI	39 x 33.5 x 17
Single flat shelf	121SCCF	15 x 12.5 x 17	241SCCF	27 x 12.5 x 17	361SCCF	39 x 12.5 x 17
Double flat shelf	122SCCF	15 x 23 x 17	242SCCF	27 x 23 x 17	362SCCF	39 x 23 x 17
Triple flat shelf	N/A	N/A	243SCCF	27 x 33.5 x 17	363SCCF	39 x 33.5 x 17
Center pump mount	N/A	N/A	24CENTER	27 x 15.5 x 17	36CENTER	39 x 15.5 x 17
Center pump mount with top shelf	N/A	N/A	24CENTERTSND	27 x 15.5 x 17	36CENTERTSND	39 x 15.5 x 17
Top pump mount	12TPM4GB	15 x 24 x 1	24TPM6GB	27 x 24 x 1	36TPM8GB	39 x 24 x 1
Top storage shelf	12TSGB	15 x 11 x 17	24TSGB	27 x 11 x 17	36TSGB	39 x 11 x 17

Replacement Parts

Part Number	Description
50101900	Plastic end cap
5010200	2" plastic connector for stacking shelves
RACKCONKIT	4 connectors and 4 caps
CN4	4" plastic connector for top pump mounts



50101900

5010200

CN4



Nexel Storage Systems

Nexel carts have a stainless steel top, two inside shelves, and come unassembled. Additional carts and complete pre-assembled systems are available. Please call for details.



Wire shelf



Stainless steel solid shelf



Cantilever shelf



Cart Dimensions	Inside Shelves	Part Number
24" x 36"	18" x 36"	NexelCart1
24" x 36"	14" x 36"	NexelCart2
24" x 36"	18" x 24"	NexelCart3
24" x 48"	18" x 36"	NexelCart4
24" x 30"	14" x 24"	NexelCart5
24" x 24"	N/A	NexelCart6

Shelf style	Dimensions	Part Number
Wire shelf	14" x 24"	S1424Z
Wire shelf	14" x 30"	S1430Z
Wire shelf	14" x 36"	S1436Z
Wire shelf	14" x 48"	S1448Z
Wire shelf	18" x 24"	S1824Z
Wire shelf	18" x 30"	S1830Z
Wire shelf	18" x 36"	S1836Z
Wire shelf	18" x 48"	S1848Z
Wire shelf	24" x 24"	S2424Z
Wire shelf	24" x 30"	S2430Z
Wire shelf	24" x 36"	S2436Z
Wire shelf	24" x 48"	S2448Z
Stainless steel solid shelf	24" x 36"	S2436SS
Stainless steel solid shelf	24" x 48"	S2448SS
Cantilever shelf	12" x 24"	CS1224C
Cantilever shelf	12" x 30"	CS1230C
Cantilever shelf	12" x 36"	CS1236C
Cantilever shelf	12" x 48"	CS1248C

Part Number	MG072C	CA5SBR	AP	AF	AW2C	AG	APL	AM
Description	72" post	Caster set, includes two locking casters	Post cap	Foot plate	Wall bracket	Non-marring floor glide	Locking post collar	Shelf clips, set of four

Flojet BIB Pumps

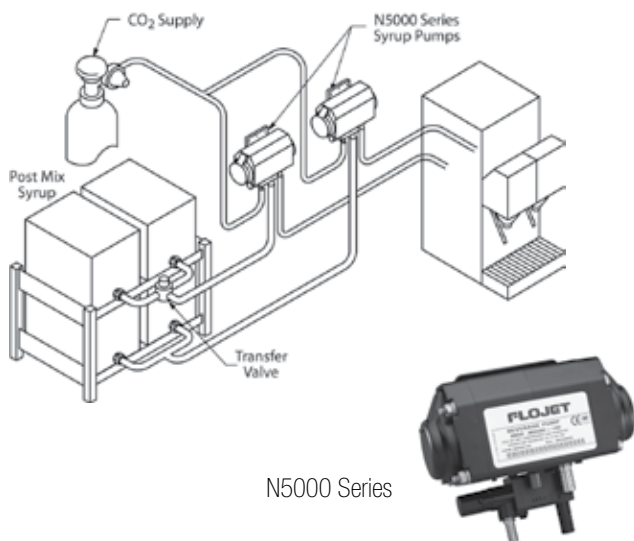

N5000 Series CO₂ pumps for syrup or juice without particulates are compact and have quick disconnect fittings for easy installation. Pumps maintain constant pressure at the dispensing valve, operate only when beverage is being dispensed, automatically shutoff when the BIB bag is empty and restart when a full bag is connected.

Use high altitude pumps for installations over 3000 feet above sea level.

Pumps deliver up to (4) 3.0 oz/sec or (2) 4.5 oz/sec valves. Service life up to 40,000 gallons. Operating temperature: 34°-120° F. Operating pressure: 20-80 psi. Five year warranty.

Part Number	Product Inlet	Product Outlet	CO ₂ Inlet
N5000130	3/8" barbed straight plastic	3/8" barbed straight plastic	1/4" plastic (Celcon)
N5000515	3/8" barbed straight plastic	3/8" barbed straight stainless steel	1/4" brass shut-off
N5000171	3/8" barbed straight plastic (Celcon)	3/8" barbed straight stainless steel	1/4" brass w offset tee
N5000140	3/8" barbed straight plastic	1/4" barbed straight stainless steel	1/4" brass shut-off
N5000153*	3/8" barbed straight plastic	1/4" barbed straight stainless steel	1/4" brass shut-off
N5000135	Service pump (none)	Service pump (none)	Service pump (none)

* High altitude pump

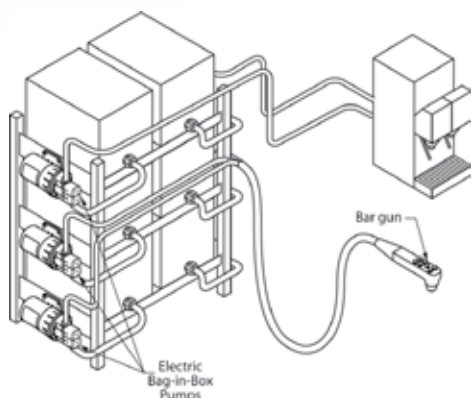

2125 Series 115V electric pump for Bag-in-Box syrups, juice concentrate (without pulp or particulate), teas, wines and liquor is ideal for use in mobile carts and vending applications where CO₂ is not available.

Built-in vacuum switch shuts off pump when bag is empty. When full bag is connected, pump will restart automatically. Pressure switch allows pump to turn on and off automatically when dispensing valve is opened or closed. Pumps are self-priming up to 6 ft. and can run dry without damage. Ports are 1/4" FPT. One year warranty.

Note: If inlet exceeds 30 psi, pump requires 30 psi water pressure regulator.

Part Number	Pressure	Flow rate
2125030A	50 psi max.	1 oz. per second
2125507A	90 psi max.	1/2 oz. per second

Flojet BIB, Juice, Smoothie and Condiment Pumps



G55 Series

G55 Series high performance, high flow rate, quiet CO₂ pump is designed for dispensing Bag-in-Box syrups, juice concentrate (without pulp or particulate), teas, wines, draft beer and liquor. Quick disconnect fittings make installation easy. Pumps maintain constant pressure at the dispensing valve, operate only when beverage is being dispensed, automatically shutoff when the BIB bag is empty and restarts with a full bag.

Pumps delivers up to (8) 3.0 oz/sec or (4) 4.5 oz/sec valves. Service life up to 100,000 gallons. High CO₂ inlet pressure capability for long runs. Operating pressure: 20-90 psi. Operating temperature: 34°-120° F. Five year warranty.

G58 Series pumps are identical to the G55 Series but are designed for dispensing BIB syrups, juice concentrates and condiments which have particulates without pulp. Flow rate 6 oz/sec. Operating pressure: 20-90 psi. Five year warranty.

G80 Pulpjet pumps are designed to dispense smoothies, BIB syrups, juice concentrates and condiments which have pulp or particles up to 1/8". High flow rate, ultimate performance and reliability. Built-in auto shutoff automatically shuts off pump when bag is empty and restarts when a full bag is connected. Quiet operation with exhaust muffler. All quick disconnect ports. Operating pressure: 20-80 psi.



G58 Series

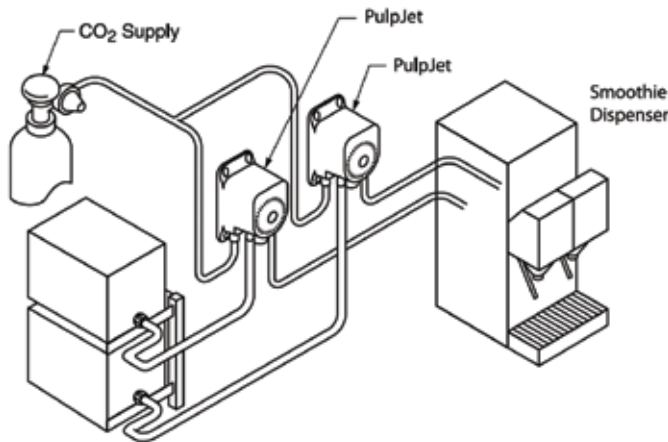

G80 Series

Part Number	Product Inlet	Product Outlet	CO ₂ Inlet
G551032A	3/8" barbed straight stainless steel	1/2" barbed straight stainless steel	1/4" brass shut-off
G551022A	3/8" barbed straight stainless steel	3/8" barbed straight stainless steel	1/4" brass shut-off
G551012A	3/8" barbed straight stainless steel	1/4" barbed straight stainless steel	1/4" brass shut-off
G581022A	3/8" barbed straight stainless steel	3/8" barbed straight stainless steel	1/4" brass shut-off
G80-1022	3/8" barbed straight stainless steel	3/8" barbed straight stainless steel	1/4" brass shut-off

Flojet Accessories



1500030A/ 1500031A



1500130A



21000255B



20308130



20982100A



20272002B



21000563



21000296A



11028008



11028508



1740003



2095502/ 2095540

Part Number	Description
1500030A	Transfer valve
1500031A	Transfer valve, high altitude
1500130A	Transfer valve, swivel elbow
1500131A	Transfer valve, high altitude, swivel elbow
21000255B	Transfer valve mounting bracket
20308130	Auto shut-off
20308131	Auto shut-off, high altitude
2095502	Syrup sold out switch for 1/4" ID tube
2095540	Syrup sold out switch for 3/8" ID tube
20982100A	Universal mounting bracket
20272002B	5000 Series slide track mtg bracket
21000563	90° slide track bracket
21000296A	G Series 4 pump plastic bracket
11028008	8 pump SS mounting panel
11028508	5000 Series 3 pump metal bracket
2PB	2 pump mounting board Flojet/Shurflo
3PB	3 pump mounting board Flojet/Shurflo
01720002	Strainer, SS 20 mesh, 1/2" barb
01720003	Strainer, SS 20 mesh, 3/8" barb
01720102	Strainer, poly 20 mesh, 1/2" barb
01720103	Strainer, poly 20 mesh, 3/8" barb
1740002	Strainer, SS 40 mesh, 1/2" barb
01740003	Strainer, SS 40 mesh, 3/8" barb
01740365	Strainer, poly 40 mesh, 1/2" barb

Transfer Valves

Vacuum operated, valves automatically change from empty to full bag without interrupting flow. Label indicates which BIB is "online." Transfer valves operate multiple banks of BIB horizontally, can be mounted in any position, and can be manually operated. 3/8" hose barbs.

Automatic Shut-Offs

Shuts off N5000 or T5000 pump automatically when BIB is empty. Comes with 1/4" straight plastic CO₂ shut-off valve.

Syrup Sold-Out Switches

Illuminates "sold out" light to indicate empty BIB and temporarily disables dispensing valve. Open at 20 psi, closed at 13 psi. 24V AC power.

Strainers

Keep debris and particles from entering your Flojet pump and other equipment. Low profile design saves space, and threaded bowl makes cleaning quick and easy.

SS = stainless steel
Poly = polypropylene



Flojet BIB Fittings

Pictures are not to scale.



Part Number	Application	Pump Series	Size"	Shape	Material	Additional Info
20324030	Syrup	N5000 & G55	1/4	Straight hose barb	Stainless steel	
20325030	Syrup	N5000 & G55	3/8	Straight hose barb	Stainless steel	
20606100	Syrup	N5000 & G55	1/2	Straight hose barb	Stainless steel	
20607100	Syrup	N5000 & G55	1/4	Elbow hose barb	Stainless steel	
20608100	Syrup	N5000 & G55	3/8	Elbow hose barb	Stainless steel	
20325031	Syrup	N5000,G55, G58	3/8	Straight hose barb	Plastic/Celcon	
21000231B	Syrup	N5000,G55, G58	1/4 OD	Straight	Plastic	John Guest
21000232B	Syrup	N5000,G55, G58	3/8 OD	Straight	Plastic	John Guest
91010003	Syrup	2125	1/4 x 3/8	Elbow, MPT x barb	Plastic	
91010052	Syrup	2125	1/4 x 1/4	Elbow, MPT x barb	Plastic	
91010004	Syrup	2125	1/4 x 3/8	Straight, MPT x barb	Plastic	
91010053	Syrup	2125	1/4 x 1/4	Straight, MPT x barb	Plastic	
1510000	CO ₂	N5000 & G55	1/4	Straight hose barb	Brass	With check valve
1520000	CO ₂	N5000 & G55	1/4	Tee hose barb	Brass	With check valve
1521000	CO ₂	N5000 & G55	1/4	Elbow hose barb	Brass	With check valve
1522000	CO ₂	N5000 & G55	1/4	Offset tee hose barb	Brass	With check valve
1523000	CO ₂	N5000 & G55	1/4	Offset elbow, left-hand	Brass	With check valve
1524000	CO ₂	N5000 & G55	1/4	Offset elbow, right-hand	Brass	With check valve
20325033	CO ₂	N5000,G55, G58	1/4	Straight hose barb	Plastic/Celcon	
21000233B	CO ₂	N5000,G55, G58	1/4 OD	Straight	Plastic	John Guest
21000234B	CO ₂	N5000,G55, G58	1/4 OD	Straight	Brass	John Guest, has shutoff



SHURflo Pumps For Syrups, Juice and Condiments



Heavy duty syrup pumps have straight through flow path for maximum efficiency, built-in automatic demand and sold-out switch, and quick disconnects for easy installation. Syrup pumps can also be used for juice concentrates without pulp or particulates. 3.4 oz/cycle. Maximum 85 psi. Minimum 20 psi. Product inlets are 3/8" plastic barbed elbow. Five year warranty.

Heavy duty juice and condiment pumps are designed for soft solids, beverages with pulp, particulates or viscous concentrates. 2.5 oz/cycle. Maximum 70 psi. Minimum 20 psi. Three year warranty.



Syrup valve



Juice valve



Juice with particulates /
Condiment valve

Single CO₂ Pumps

Part Number	Application	Product Outlet	CO ₂ Inlet	Additional Info
9438431	Syrup	3/8" SS barb elbow	1/4" plastic barb elbow, check valve	P-bracket
9438431	Syrup	3/8" SS barb elbow	1/4" plastic barb "T," check valve	P-bracket
9436000	Syrup	1/4" SS barb elbow	1/4" plastic barb elbow, check valve	Standard bracket
9436031	Syrup	3/8" SS barb elbow	1/4" plastic barb "T," check valve	Standard bracket
9436038	Syrup	3/8" SS barb elbow	1/4" plastic barb elbow, check valve	Standard bracket
9436040	Syrup	1/4" SS barb elbow	1/4" plastic barb "T," check valve	Standard bracket
9436041	Syrup	3/8" SS barb elbow	1/4" plastic barb "T," check valve	Standard bracket, Pepsi literature
9444148	Syrup	N/A	N/A	Service pump, no fittings
9436650	Syrup	1/4" SS barb elbow	1/4" plastic barb elbow, check valve	Standard bracket, high altitude
9436649	Syrup	1/4" SS barb elbow	1/4" plastic barb "T," check valve	Standard bracket, high altitude
9436648	Syrup	3/8" SS barb elbow	1/4" plastic barb "T," check valve	Standard bracket, high altitude
9436006	Syrup	3/8" SS barb elbow	1/4" plastic barb elbow, check valve	Standard bracket, CC label
9444038	Syrup	1/4" SS barb elbow	1/4" plastic barb elbow, check valve	Standard bracket, CC label
9436019	Syrup	3/8" SS barb elbow	1/4" brass barb elbow, check valve	Standard bracket, CC label
9436002	Syrup	1/4" SS barb elbow	1/4" brass barb "T," check valve	Standard bracket, CC label
9444117	Syrup	N/A	N/A	Service pump, no fittings, CC label
9444039	Syrup	1/4" SS barb elbow	1/4" plastic barb elbow, check valve	Std. bracket, high altitude, CC label
9436005	Juice/Syrup	3/8" black plastic barb elbow	1/4" plastic barb elbow, check valve	Standard bracket
9436012	Condiments	3/8" black plastic barb elbow	1/4" plastic barb "T," check valve	Standard bracket
9436015	Condiments	3/8" black plastic barb elbow	1/4" plastic barb elbow, check valve	Standard bracket

Single Electric Pumps



Part #	Application	Barb	PSI	Flow Rate	Additional Information
SLV10CA41	Syrup	3/8"	40	1.0 GPM	12V DC, low volume transfer pump
SLV10CB41	Syrup	3/8"	40	1.0 GPM	24V DC, low volume transfer pump
9443700	Syrup	3/8"	60	0.95 GPM	115-24V, transformer included



SHURflo Brix Pumps



The brix pump precisely proportions two non-carbonated liquids in an exact ratio, independent of flow rate and pressure, which eliminates the need for ongoing brix adjustments at the dispensing valve. The source pressure of one of the proportioned liquids eliminates the need for CO₂ or electric power.

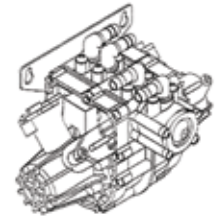

All brix pumps have a metal mounting bracket, 3-way sanitizing valve, and vacuum shut-off valve (sold out feature) which keeps the system primed when water or syrup flow stops. Maximum 50 psi. Three year warranty.

Part Number	Ratio	Capacity
9426301	3:1	8 boxes
9426303	4:1	8 boxes
9426305	5:1	8 boxes
9426306	5.3:1 (6:1 APR for FCB)	8 boxes
9426307	7.7:1	8 boxes
9426317	4.2:1 (no sold out/shut-off)	8 boxes
9440202	Valve kit, Brix II	N/A

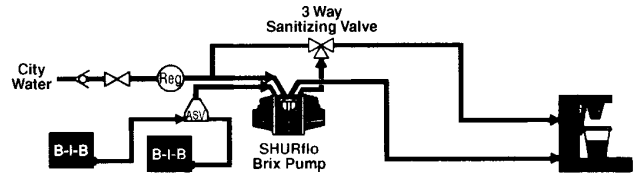
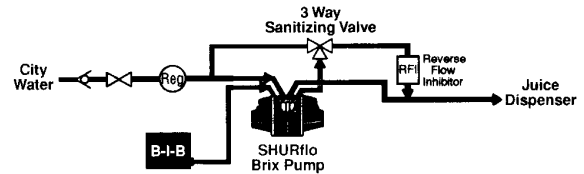
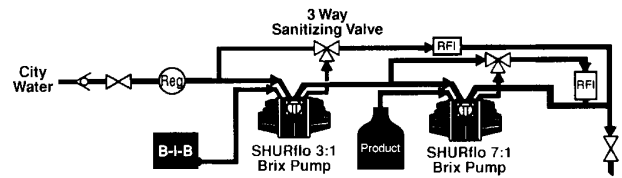

Brix Pump Fill Systems

Part Number	Description
WPS1	Single product system
WPS2	Double product system
WPS3	Triple product system

Brix Manifolds

Part Number	Description
PMSA311	Single product
PMSA312	Double product
PMSA313	Triple product



WPS2, 2 product brix pump fill system

Gas Pump Fill Systems

Part Number	Description
GPS2	Two product fill system
GPS3	Three product fill system



GPS2, 2 product fill system

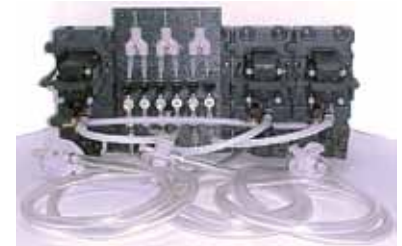

GPS3, 3 product fill system

SHURflo Accessories



9435950



9435008



9405400



9405600



8401000



9406833



9490500

Gas permeable air vent releases trapped air in the bag-in-box, preventing spitting and foaming at the dispensing valve.

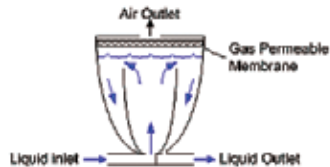

Part Number	Description
9435950	100 quick disconnect clips & 50 gas clips for CC pumps
9435910	100 quick disconnect clips & 50 gas clips for GB pumps
9435008	Bag selector valve, gas pump, 3/8" barb
9435003	Bag selector valve, gas pump, 3/8" barb elbow
165110	Bag selector valve, electric pump, 3/8" barb
9405400	Inline vacuum regulator with fittings
9405600	Sanitizing valve, 3-way, 3/8" barb elbow fittings
8401000	Reverse flow inhibitor with fittings
9406801	Sold-out switch kit, 8-30 psi, 1/4" SS "T" barb, 115V, LED light
9406820	Sold-out switch kit, 8-30 psi, 3/8" SS "T" barb, 115V, LED light
9406833	Mini sold-out switch kit, 25-60 psi, 1/4" SS barb, 115V
9406831	Mini soldout switch kit, 1520 psi, 1/4" SS barb, 115V, LED
9490500	Gas permeable air vent for BIBs

SHURflo Fittings



9417807



9417801



9417816



9417817



9417822



9417823

Part Number	Application	Barb Size	Shape	Material	Additional Info
9417801	Syrup	3/8"	Elbow	Plastic	Liquid in
9417807	Syrup	1/4"	Elbow	Stainless steel	Liquid in
9417851	Syrup	1/2"	Elbow	Stainless steel	Liquid in
9417819	Syrup	3/8"	Straight	Stainless steel	Liquid in
9417827	Syrup	1/2"	Straight	Stainless steel	Liquid in
9417818	Syrup	3/8"	Elbow	Stainless steel	Liquid out
9417803	Syrup	3/8"	Straight	Plastic	Liquid out
9417824	Syrup	3/8" (no barb)	Straight	Plastic	Liquid out, John Guest
9417820	Syrup	1/2"	Elbow	Plastic	Liquid out (brix)
9417825	Syrup	1/2"	Straight	Plastic	Liquid out (brix)
9417826	Syrup	3/8"	Elbow	Polypropylene	Liquid out (juice)
9417816	CO ₂	1/4"	Elbow	Yellow plastic	Check valve
9417817	CO ₂	1/4"	Tee	Yellow plastic	Check valve
9417822	CO ₂	1/4"	Elbow	Brass	Check valve
9417823	CO ₂	1/4"	Tee	Brass	Check valve
9417802	CO ₂	1/4"	Elbow	Plastic	No check valve
9417805	CO ₂	1/4"	Straight	Plastic	No check valve
9405700	CO ₂		Straight	Plastic	Muffler kit, silencer for exhaust port



SYRUP SYSTEMS



Flojet and SHURflo Pump Systems

BIB pump systems make installation a breeze! Each pump system has more than one pump (2 to 6) mounted on a plastic mounting board, quick change pump mounting brackets, air manifold, tubing and connectors.

Additional configurations are available upon request (minimum quantities required) in a variety of fittings, inlet BIB tubing, air manifolds and BIB connectors. Please call ABS customer service for details.



Part Number	# Pumps	Pump Mfr.	Connectors	Product Outlet	CO ₂ Inlet	Additional Info
N5000502	1	Flojet	Coke	1/4" SS barb straight	1/4" brass barb straight, check valve	Slide Track bracket
N5000502Q	1	Flojet	QCD	1/4" SS barb straight	1/4" brass barb straight, check valve	Slide Track bracket
9444041C	1	Shurflo	Coke	1/4" SS barb elbow	1/4" plastic barb elbow, check valve	Slide Track bracket
9444041Q	1	Shurflo	QCD	1/4" SS barb elbow	1/4" plastic barb elbow, check valve	Slide Track bracket
N5000501	1	Flojet	Coke	3/8" SS barb straight	1/4" brass barb straight, check valve	Slide Track bracket
N5000501Q	1	Flojet	QCD	3/8" SS barb straight	1/4" brass barb straight, check valve	Slide Track bracket
9444061C	1	Shurflo	Coke	3/8" SS barb elbow	1/4" plastic barb elbow, check valve	Slide Track bracket
9444061Q	1	Shurflo	QCD	3/8" SS barb elbow	1/4" plastic barb elbow, check valve	Slide Track bracket
N5000517	2	Flojet	Coke	1/4" SS barb straight	1/4" brass barb elbow, check valve	Universal modular board
N5000617	2	Flojet	QCD	1/4" SS barb straight	1/4" brass barb elbow, check valve	Universal modular board
9437642C	2	Shurflo	Coke	1/4" SS barb elbow	1/4" brass barb elbow, check valve	Universal modular board
9437642Q	2	Shurflo	QCD	1/4" SS barb elbow	1/4" brass barb elbow, check valve	Universal modular board
N5000820A	2	Flojet	Coke	3/8" SS barb straight	1/4" brass barb elbow, check valve	Universal modular board
N5000920A	2	Flojet	QCD	3/8" SS barb straight	1/4" brass barb elbow, check valve	Universal modular board
9437662C	2	Shurflo	Coke	3/8" SS barb elbow	1/4" brass barb elbow, check valve	Universal modular board
9437662Q	2	Shurflo	QCD	3/8" SS barb elbow	1/4" brass barb elbow, check valve	Universal modular board
N5000830A	3	Flojet	Coke	3/8" SS barb straight	1/4" brass barb elbow, check valve	Universal modular board
N5000930A	3	Flojet	QCD	3/8" SS barb straight	1/4" brass barb elbow, check valve	Universal modular board
9437862C	3	Shurflo	Coke	3/8" SS barb elbow	1/4" brass barb elbow, check valve	Universal modular board
9437862Q	3	Shurflo	QCD	3/8" SS barb elbow	1/4" brass barb elbow, check valve	Universal modular board
N5000840A	4	Flojet	Coke	3/8" SS barb straight	1/4" brass barb elbow, check valve	Universal modular board
N5000940A	4	Flojet	QCD	3/8" SS barb straight	1/4" brass barb elbow, check valve	Universal modular board

Advanced Beverage Solutions • Ph: 877-814-2271 • Fax: 847-524-1710 • E-mail: absos@absone.com • Visit us online at www.absone.com



Flojet and SHURflo Pump Systems

Pre-plumbed boards simplify post-mix system installation, saving time and money. Assembled pump boards are available in any combination of pumps and fittings to suit your needs.

Pump boards can be ordered in 6, 8, and 10 pump configurations with any SHURflo or Flojet pump model, and any style of bag connector or regulator. When ordering, please specify portrait or landscape configuration.

Different pump, fitting, bag connector and bracket configurations are available upon request. Please call ABS customer service for details.

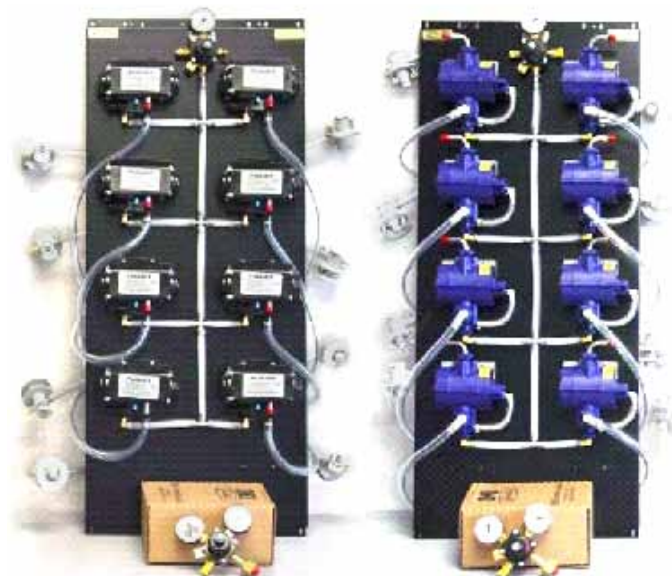

Part Number	# Pumps	Pump Mfr.	Connectors	Regulators	Additional Info
PB6F6CR	6	Flojet	Coke	Taprite High and Low	Powder Coat Metal Bracket
PB6F6QR	6	Flojet	QCD	Taprite High and Low	Powder Coat Metal Bracket
PB6S6CR	6	Shurflo	Coke	Taprite High and Low	Powder Coat Metal Bracket
PB6S6QR	6	Shurflo	QCD	Taprite High and Low	Powder Coat Metal Bracket
PB8F8CR	8	Flojet	Coke	Taprite High and Low	Powder Coat Metal Bracket
PB8F8QR	8	Flojet	QCD	Taprite High and Low	Powder Coat Metal Bracket
PB8S8CR	8	Shurflo	Coke	Taprite High and Low	Powder Coat Metal Bracket
PB8S8QR	8	Shurflo	QCD	Taprite High and Low	Powder Coat Metal Bracket
PB10F10CR	10	Flojet	Coke	Taprite High and Low	Powder Coat Metal Bracket
PB10F10QR	10	Flojet	QCD	Taprite High and Low	Powder Coat Metal Bracket
PB10S10CR	10	Shurflo	Coke	Taprite High and Low	Powder Coat Metal Bracket
PB10S10QR	10	Shurflo	QCD	Taprite High and Low	Powder Coat Metal Bracket



Brix Tools

Having the proper ratio of syrup and carbonated water makes a big difference in the flavor of soft drinks. Over time dispensing valves can get out of adjustment. Measuring the brix is an important step in the process of ensuring the right amount of sweetness in soft drinks to keep customers coming back for more.

The quality assurance kit can be modified to your specifications. Multiples of any component can be added for an additional charge.

Part Number	Application	Description
161054	McCann's	Quality assurance kit
050090	Lancer	Brix cup, universal, graduated marks
050085	Lancer	Brix cup, 4.4:1
050088	Lancer	Brix cup, 5.4:1
999012	McCann's	Brix cup, 5:1 and 5.5:1, 8 oz.
999430	McCann's	Brix cup, 4.4:1 and 5.4:1
999450	McCann's	Brix cup, 4.5:1 and 5.5:1, 8 oz.
999475	McCann's	Brix cup, 4.75:1 and 5.5:1, 8 oz.
540031/02SP	Lancer	Syrup separator, yellow, 2 prong for LEV 3.0
540201/02SP	Lancer	Syrup separator, black, 3 prong for LEV 4.5
822014/02	Lancer	Syrup separator, Lancer 145, 4.5 valve
823457	Lancer	Syrup separator, Lancer FS
PH1083	Wunder-Bar	Syrup separator, all Wunder-Bar valves
1090	Flomatic	Syrup separator, Flomatic syrup valves
1091	Flomatic	Syrup separator, Flomatic juice valves
108900	Flomatic	Syrup separator, Flomatic "S" bypass tube
108902	Flomatic	Syrup separator, Flomatic "S" tube seal
1010859	Cornelius	Syrup separator, Cornelius "S" bypass
101062	Dole	Syrup separator, Dole fast flow valve
2701	Pepsi	Pepsi carbonation tester, complete assembly*
540007/01	Lancer	Lancer carbonation tester, complete assembly*
RHB32	All	Refractometer, 0-32% sugar/brix
220018/01	Lancer	Screwdriver, long
220086	Lancer	Nozzle wrench, LEV 3.0
521950	Lancer	Extractor tool assembly

* Carbonation tester parts can be found in the Water Systems section with carbonator parts and accessories.

See Installation Products for beverage line cleaners and equipment.



Pepsi carbonation tester

Lancer carbonation tester



Encore BIB Connector

Encore is a single connector/fitment valve system that is easy to use, improves reliability, and will eliminate service calls related to using the wrong combination of connector (QCD, PCSS or PCS) and fitment (PCSS or DET) - 6 possible combinations.

Conversion to the Encore connector yields immediate benefits but the maximum benefits are realized when both the Encore connector and fitment are used.

Encore benefits:

- Selected as “best in class” connector/fitment system by U.S. customers and bottlers
- Customer friendly, ergonomic collar design
- Smooth and simple one step connection, no training required
- Features positive stop which provides a secure connection and eliminates potential to over torque or strip threads
- Triple seal design eliminates leak potential and no drips on disconnect
- Minimizes/eliminates connector driven service calls
- No negative impact to bag evacuation
- Seven year life expectancy
- Provides consistent full cap position on all filling equipment and eliminates high cap position (out of full cap)
- No need to modify filler equipment

Encore connector
Part # 33230



Encore fitment valve
Part # 33235



Encore connector and fitment valve cut-away

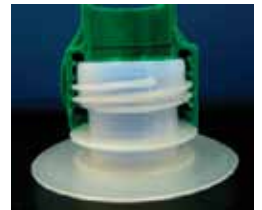

Encore connector and fitment valve cut-away



Connector/Fitment Compatibility Chart

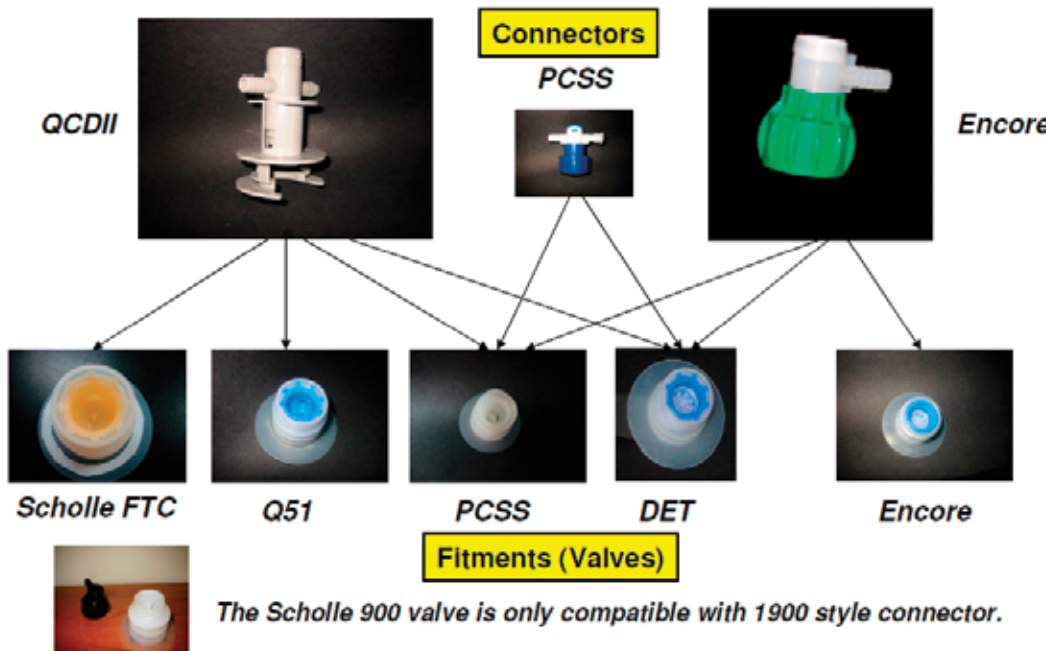

Note:

- The Encore connector is only compatible with the DET and PCSS fitment. The Encore connector does not work with the Q51 or the Scholle FTC fitment
- The QCD-II connector is compatible with the Q51, DET, PCSS and Scholle FTC fitments
- The only connector that is compatible with Scholle 900 fitment is the Scholle 1900 style connector
- The Encore fitment is only compatible with the Encore connector



BIB Connectors and Adapters

Part Number	Application	Description
33020	GB	Liqui-Box QCD-II connector
33120	GB	Liqui-Box QCD-III, special application
28007	GB	Liqui-Box QCD-II poppet valve O-ring
28009	GB	Liqui-Box QCD-II probe O-ring
28011	GB	Liqui-Box QCD-II stem O-ring
31041	GB	Liqui-Box barb cap (B30S2)
33019	GB	Liqui-Box flush adapter
33029	GB	Liqui-Box bag faucet
1000228	GB	Tomlinson HFSR faucet
820291	CC	Lancer BIB red connector, 3/8"
28688	CC	Lancer sanitizing BIB adapter
050249	CC	Lancer figal to BIB adapter
170060	CC	Lancer depressurizer/vent
050900901A	PC	Raypak PCSS connector - old style
050501501A	PC	Raypak PCS connector - new style
050502401A	PC	Raypak Diet PCSS connector
050502301A	PC	Raypak plunger assembly
3210208	PC	Raypak PCS connector O-ring kit
1137404	PC	Raypak PCS connector end cap
201184	Wine	Scholle "T" connector
202004	Wine	Scholle "L" connector
1000202	Wine	Scholle HFSP faucet



Nexel is a registered trademark of Nexel Industries, Inc., Port Washington, New York.
 Lancer is a registered trademark of Lancer Corporation, San Antonio, Texas.
 Pepsi is a registered trademark of PepsiCo Inc., Purchase, New York.
 Flomatic is a registered trademark of Manitowoc Foodservice, New Port Richey Florida.
 Cornelius is a registered trademark of IMI Cornelius, Inc., Osseo, Minnesota.
 Wunder-Bar is a registered trademark of Automatic Bar Controls, Inc., Vacaville, California.

Tank Disconnects and Plugs

Part Number	Application	Description
21110227	CC	Gas socket, 1/4" barb, long
21110229	CC	Liquid socket, 1/4" barb, long
21117027	CC	Gas socket, 1/4" flare, long
21117029	CC	Liquid socket, 1/4" flare, long
21120257	CC	Gas socket, 1/4" barb, short
21120259	CC	Liquid socket, 1/4" barb, short
21127057	CC	Gas socket, 1/4" flare, short
21127059	CC	Liquid socket, 1/4" flare, short
27110077	GB	Gas socket, 1/4" flare, gray
27110099	GB	Liquid socket, 1/4" flare, gray
27110277	GB	Gas socket, 1/4" barb, gray
27110299	GB	Liquid socket, 1/4" barb, black
27110399	GB	Liquid socket, 3/8" barb, black
2KG720	GB	Tank Plug, gas, 1/4" FFL
2KL720	GB	Tank Plug, liquid, 1/4" FFL
2KGF15	GB	Tank Plug, gas, SS, 1/4" MPT
2KLF15	GB	Tank Plug, liquid, SS, 1/4" MPT
2KGCC	CC	Tank Plug, gas
2KLCC	CC	Tank Plug, liquid



Taprite is a registered trademark of Taprite-Fassco Mfg., Inc., San Antonio, Texas.
 McCann's is a registered trademark of McCann's Engineering, a Manitowoc Company, Los Angeles, California.
 Flojet is a registered trademark of ITT Industries, Foothill Ranch, California.
 SHURflo is a registered trademark of SHURflo, LLC, Cypress, California.
 QCD II is a registered trademark of Liqui-Box Corporation, a DuPont Company, Worthington, Ohio.
 Raypak is a registered trademark of The Plastics Division of DS Smith Plastics LTD, London, United Kingdom.
 Scholle is a registered trademark of Scholle Corporation, Irvine, California.